

TOOL LIST

4/2/2024 12:54 PM

\CAM\SRCPRG\FMI\WJ10390\WJ10390-03\MILL\MCX-
SOURCE\WJ10390-03-A.MCAM

FILTERED: NO

TOOL #: **NAME: 3/8 3FL CHPBRK 0.01R 1"LOC**

TYPE: Bull endmill
DIAMETER: 0.375
CORNER RADIUS 0.01
LENGHT OF CUT: 1.0
STICKOUT: 1.2
TIP ANGLE: NA
FLUTES: 3
FPT: 0.0018 SFM: 932.5916
MANUFACTURER: YG-1
MANUFACTURER ID: JAI38912
HOLDER: 40-840-3/8z
LIBRARY: \\p1files01\CAM\Mastercam\Shared Mastercam
2021\mill\Tools\FM7-TOOLHOLDERS-
MASTER.tooldb

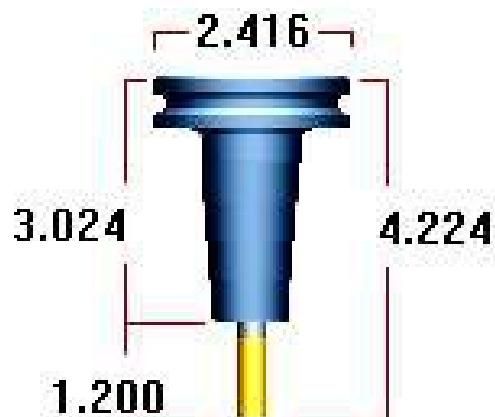

reference only

TOOL #: **NAME: 3/8 3FL FINISHER 1"LOC**

TYPE: Flat endmill
DIAMETER: 0.375
CORNER RADIUS 0.0
LENGHT OF CUT: 1.0
STICKOUT: 1.2
TIP ANGLE: NA
FLUTES: 3
FPT: 0.0018 SFM: 932.5916
MANUFACTURER: YG-1
MANUFACTURER ID: JAG95907
HOLDER: 40-840-3/8z
LIBRARY: \\p1files01\CAM\Mastercam\Shared Mastercam
2021\mill\Tools\FM7-TOOLHOLDERS-
MASTER.tooldb

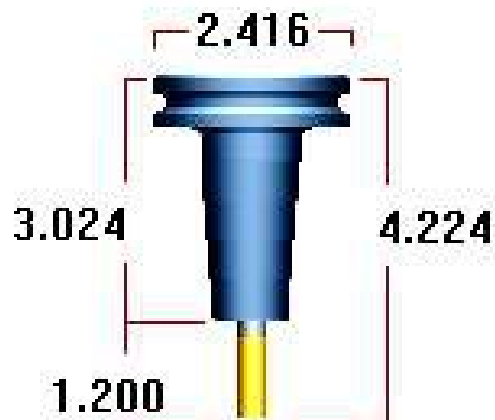

reference only

TOOL #: 6 NAME: 1/4 X 90 DEG. CHAMFERMILL 4FL COATED

TYPE: Chamfer mill
DIAMETER: 0.25
CORNER RADIUS 0.0
LENGHT OF CUT: 0.125
STICKOUT: 1.2
TIP ANGLE: NA
FLUTES: 4
FPT: 0.005 **SFM:** 981.6754
MANUFACTURER: DESTINY
MANUFACTURER ID: AS21690 OR SIMILAR
HOLDER: 40-840-1/4z-4
LIBRARY: \\p1files01\CAM\Mastercam\Shared Mastercam
2021\mill\Tools\FM7-TOOLHOLDERS-
MASTERMILL

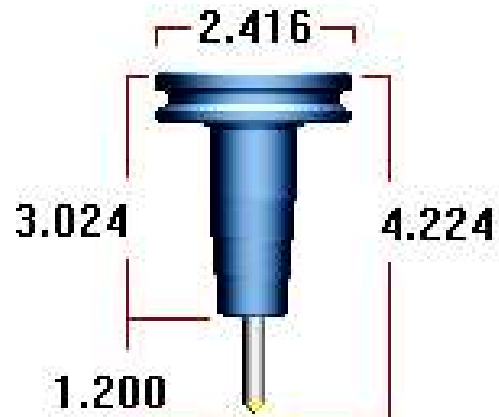

reference only

TOOL #: 9 NAME: 5/8 5FL CHPBRKR TPLUS 1.625LOC

TYPE: Bull endmill
DIAMETER: 0.625
CORNER RADIUS 0.03
LENGHT OF CUT: 1.625
STICKOUT: 1.8
TIP ANGLE: NA
FLUTES: 5
FPT: 0.002 **SFM:** 572.644
MANUFACTURER: HELICAL
MANUFACTURER ID: 83118
HOLDER: 40-840-5/8z-4
LIBRARY: \\p1files01\CAM\Mastercam\Shared Mastercam
2021\mill\Tools\FM7-TOOLHOLDERS-
MASTERMILL

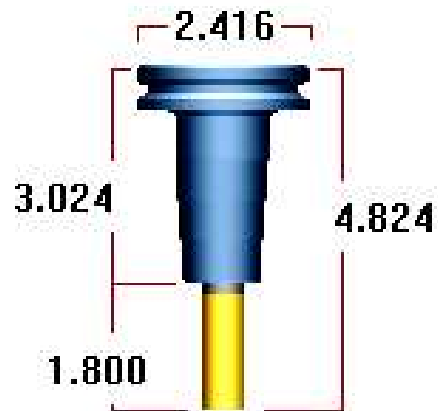

reference only

TOOL #: 10 NAME: 1/2 6FL FINISHER TPLUS 1.625LOC

TYPE: Flat endmill
DIAMETER: 0.5
CORNER RADIUS 0.0
LENGHT OF CUT: 1.625
STICKOUT: 1.8
TIP ANGLE: NA
FLUTES: 6
FPT: 0.0016 **SFM:** 346.8586
MANUFACTURER: HELICAL
MANUFACTURER ID: 59911
HOLDER: 40-840-1/2z-4
LIBRARY: \\p1files01\CAM\Mastercam\Shared Mastercam
2021\mill\Tools\FM7-TOOLHOLDERS-
MASTERCAM

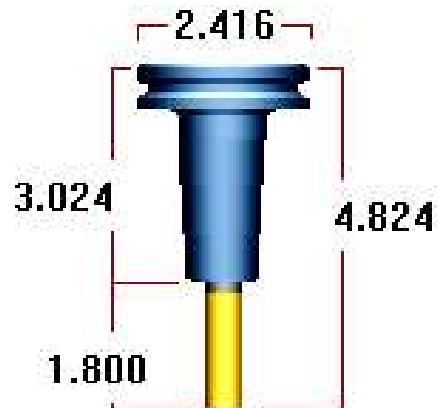

reference only

TOOL #: 11 NAME: 3/8 5FL CHPBRK TPLUS .750 LOC

TYPE: Bull endmill
DIAMETER: 0.375
CORNER RADIUS 0.02
LENGHT OF CUT: 0.75
STICKOUT: 1.1
TIP ANGLE: NA
FLUTES: 5
FPT: 0.0011 **SFM:** 441.7539
MANUFACTURER: HELICAL
MANUFACTURER ID: 83101
HOLDER: 40-840-3/8z
LIBRARY: \\p1files01\CAM\Mastercam\Shared Mastercam
2021\mill\Tools\FM7-TOOLHOLDERS-
MASTERCAM

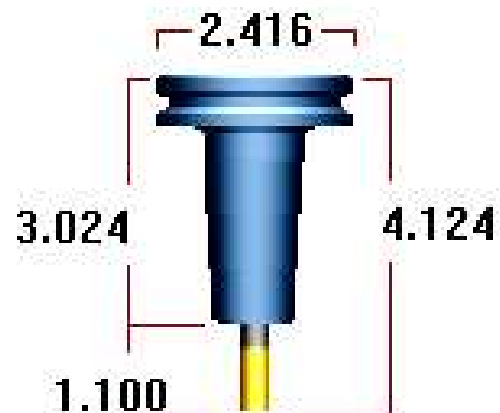

reference only

TOOL #: 12 NAME: 3/8 5FL FINISHER TPLUS .750 LOC

TYPE: Flat endmill
DIAMETER: 0.375
CORNER RADIUS 0.0
LENGHT OF CUT: 0.75
STICKOUT: 1.1
TIP ANGLE: NA
FLUTES: 5
FPT: 0.0014 **SFM:** 343.5864
MANUFACTURER: HELICAL
MANUFACTURER ID: 82529
HOLDER: 40-840-3/8z
LIBRARY: \\p1files01\CAM\Mastercam\Shared Mastercam
2021\mill\Tools\FM7-TOOLHOLDERS-
MASTERCAM

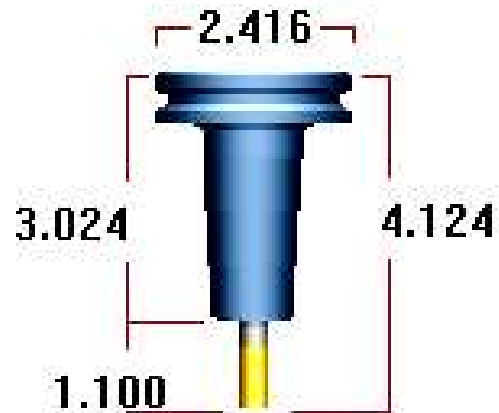

reference only

TOOL #: 13 NAME: 1/4 CHBRK EM R0.01 3FL RGH

TYPE: Bull endmill
DIAMETER: 0.25
CORNER RADIUS 0.01
LENGHT OF CUT: 0.5
STICKOUT: 0.8
TIP ANGLE: NA
FLUTES: 3
FPT: 0.0012 **SFM:** 916.2304
MANUFACTURER: HELICAL
MANUFACTURER ID: 82717
HOLDER: 40-840-1/4z-4
LIBRARY: \\p1FILES01\CAM\Mastercam\Shared Mastercam
2021\mill\Tools\FM7-UMC1000.tooldb

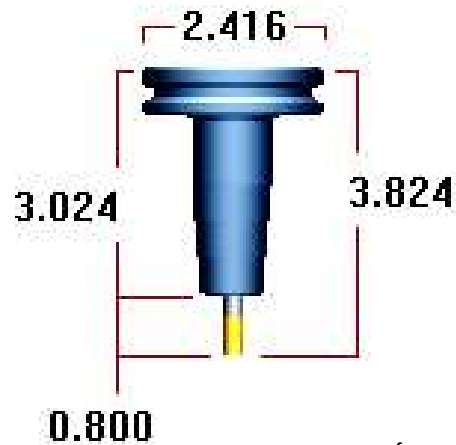

reference only

TOOL #: 14 NAME: 1/4 EM 3FL .500 LOC FIN

TYPE: Flat endmill
DIAMETER: 0.25
CORNER RADIUS: 0.0
LENGHT OF CUT: 0.5
STICKOUT: 0.8
TIP ANGLE: NA
FLUTES: 3
FPT: 0.005 **SFM:** 800.0
MANUFACTURER: HELICAL
MANUFACTURER ID: 01155
HOLDER: 40-840-1/4z-4
LIBRARY: \\p1files01\cam\Mastercam\Shared Mastercam
2021\mill\Tools\FM7-UMC1000.tooldb

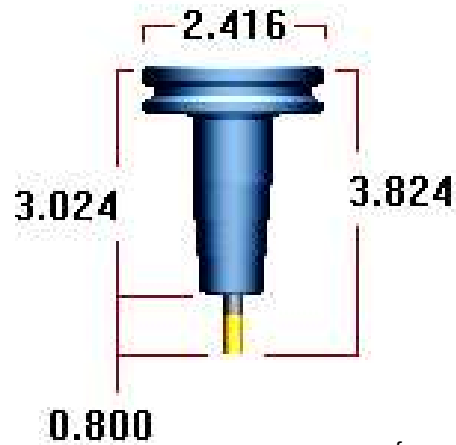

reference only

TOOL #: 15 NAME: 1/2 SPOTDRILL

TYPE: Spot drill
DIAMETER: 0.5
CORNER RADIUS: 0.0
LENGHT OF CUT: 0.3
STICKOUT: 1.5
TIP ANGLE: 90.0
FLUTES: 2
FPT: 0.001 **SFM:** 69.8953
MANUFACTURER: NA
MANUFACTURER ID: NA
HOLDER: C4C5-0020
LIBRARY: C:\Users\Public\Documents\Shared Mastercam
2021\mill\Tools\FM7-UMC1000.tooldb

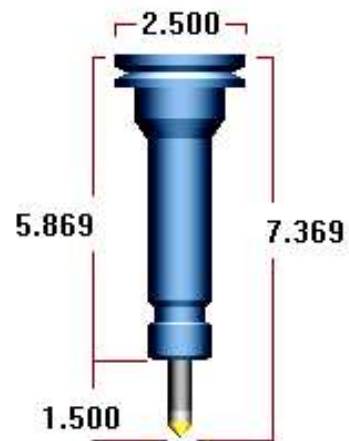

reference only

TOOL #: 16 NAME: #7 DRILL STUB

TYPE: Drill
DIAMETER: 0.201
CORNER RADIUS 0.0
LENGHT OF CUT: 1.2
STICKOUT: 1.5
TIP ANGLE: 135.0
FLUTES: 2
FPT: 0.0018 **SFM:** 302.9207
MANUFACTURER: NA
MANUFACTURER ID: NA
HOLDER: C4C5-0016
LIBRARY: C:\Users\Public\Documents\Shared Mastercam
2021\mill\Tools\FM7-TOOLHOLDERS-
MASTERCAM

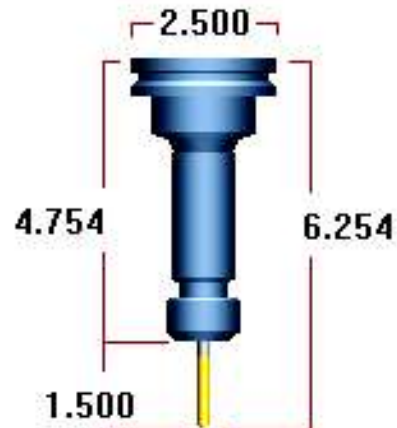

reference only

TOOL #: 17 NAME: 1/4-20 HIGH SPIRAL CUT TAP

TYPE: Right-hand tap
DIAMETER: 0.25
CORNER RADIUS 0.0
LENGHT OF CUT: 0.5
STICKOUT: 1.5
TIP ANGLE: NA
FLUTES: 3
FPT: 0.05 **SFM:** 17.4738
MANUFACTURER: OSG
MANUFACTURER ID: NA
HOLDER: C4C5-0016
LIBRARY: C:\Users\Public\Documents\Shared Mastercam
2021\mill\Tools\FM7-UMC1000.tooldb

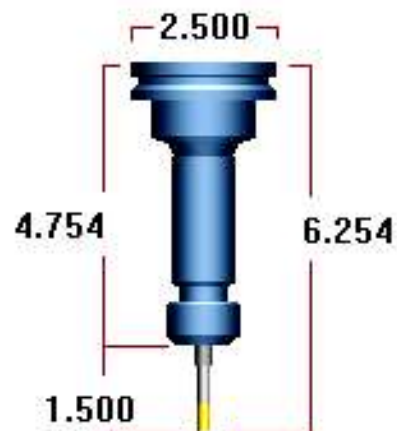

reference only

TOOL #: 18 NAME: 1/4 5FL CHPBRKR TPLUS .500 LOC

TYPE: Bull endmill
DIAMETER: 0.25
CORNER RADIUS 0.02
LENGHT OF CUT: 0.5
STICKOUT: 1.0
TIP ANGLE: NA
FLUTES: 5
FPT: 0.0004 **SFM:** 310.8639
MANUFACTURER: HELICAL
MANUFACTURER ID: 83097
HOLDER: 40-840-1/4z-4

LIBRARY: \\p1files01\CAM\Mastercam\Shared Mastercam
2021\mill\Tools\FM7-TOOLHOLDERS-
MASTERCAM

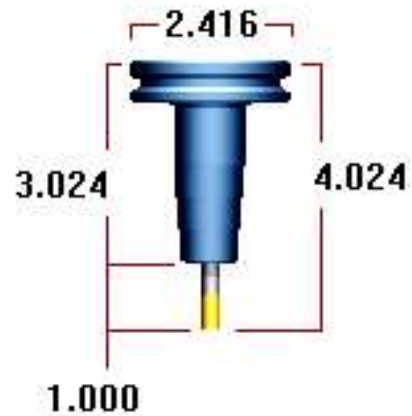

reference only